

PROJECT: **FV INDIANA SEINE SKIFF**

TITLE: **GENERAL ARRANGEMENT PLAN AND PROFILE**

**COASTWISE MARINE DESIGN INC.**  
 COASTWISEMARINEDESIGN@GMAIL.COM  
 360-301-6400

**NORTHWINDS WELDING INC.**  
 peter@northwindswelding.com  
 360-379-0487

DATE: **APRIL 20, 2014**

DESIGNED BY: **ANTONIO SALGUERO**

SCALE: **3/8" = 1'**

SHEET: **1 OF 21**

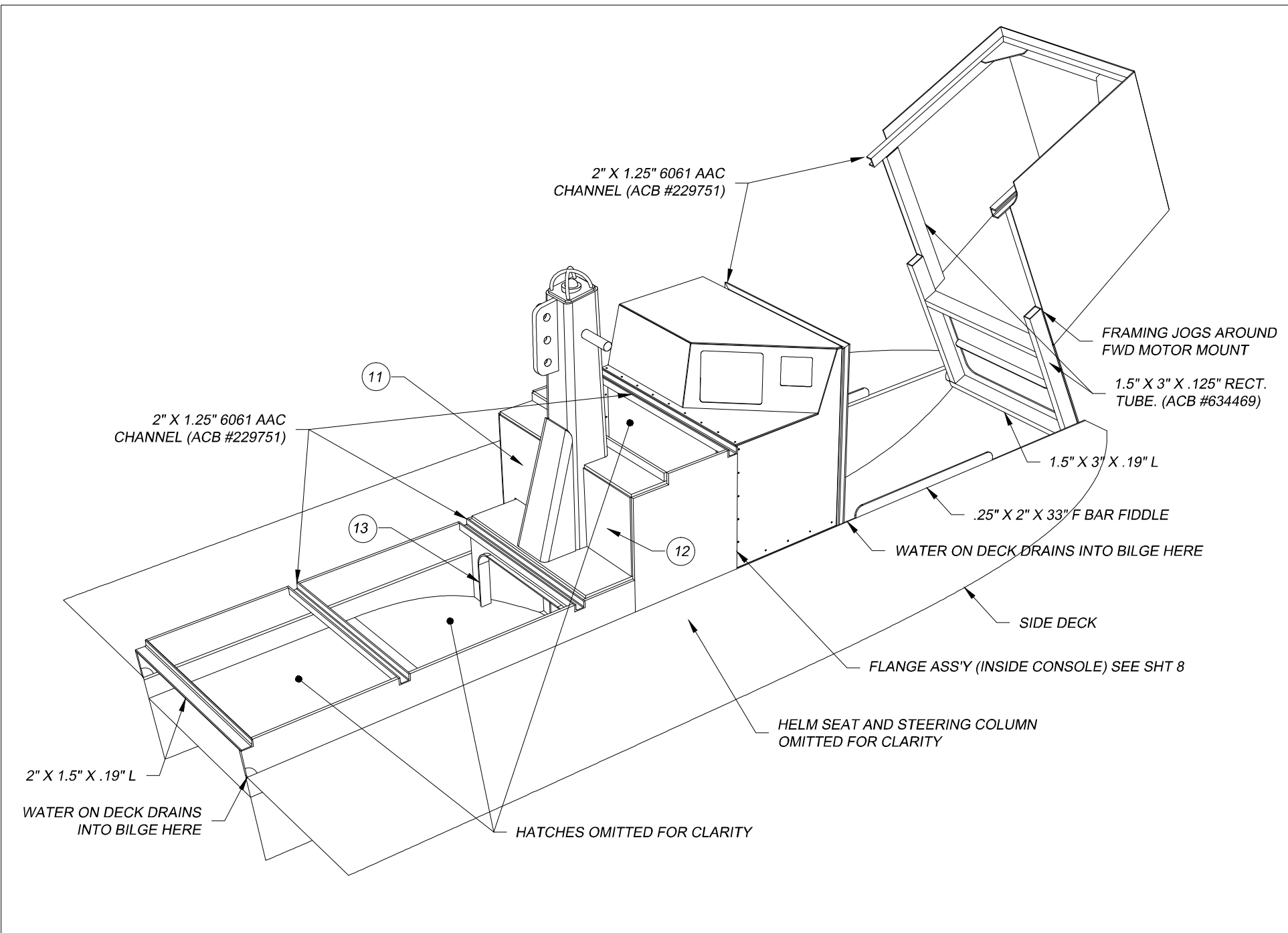

PROJECT: <b>FV INDIANA SEINE SKIFF</b>		TITLE: <b>GENERAL ARRANGEMENT PERSPECTIVE</b>	
<b>COASTWISE MARINE DESIGN INC.</b> COASTWISEMARINEDESIGN@GMAIL.COM 360-301-6400		<b>NORTHWINDS WELDING INC.</b> peter@northwindswelding.com 360-379-0487	
DATE:	APRIL 20, 2014	DESIGNED BY:	ANTONIO SALGUERO
SCALE:	NTS	SHEET:	2 OF 21

**NOTE:**

1. .5" PARTS SHOWN ONLY
2. ALL JOINTS .375" CONT. WELDS
3. PART #8 (BATTERY SHELF) IS REMOVABLE TO ACCESS STUFF. BOX. DRILL, C'SINK AND TAP FOR 1/4" MACHINE SCREWS

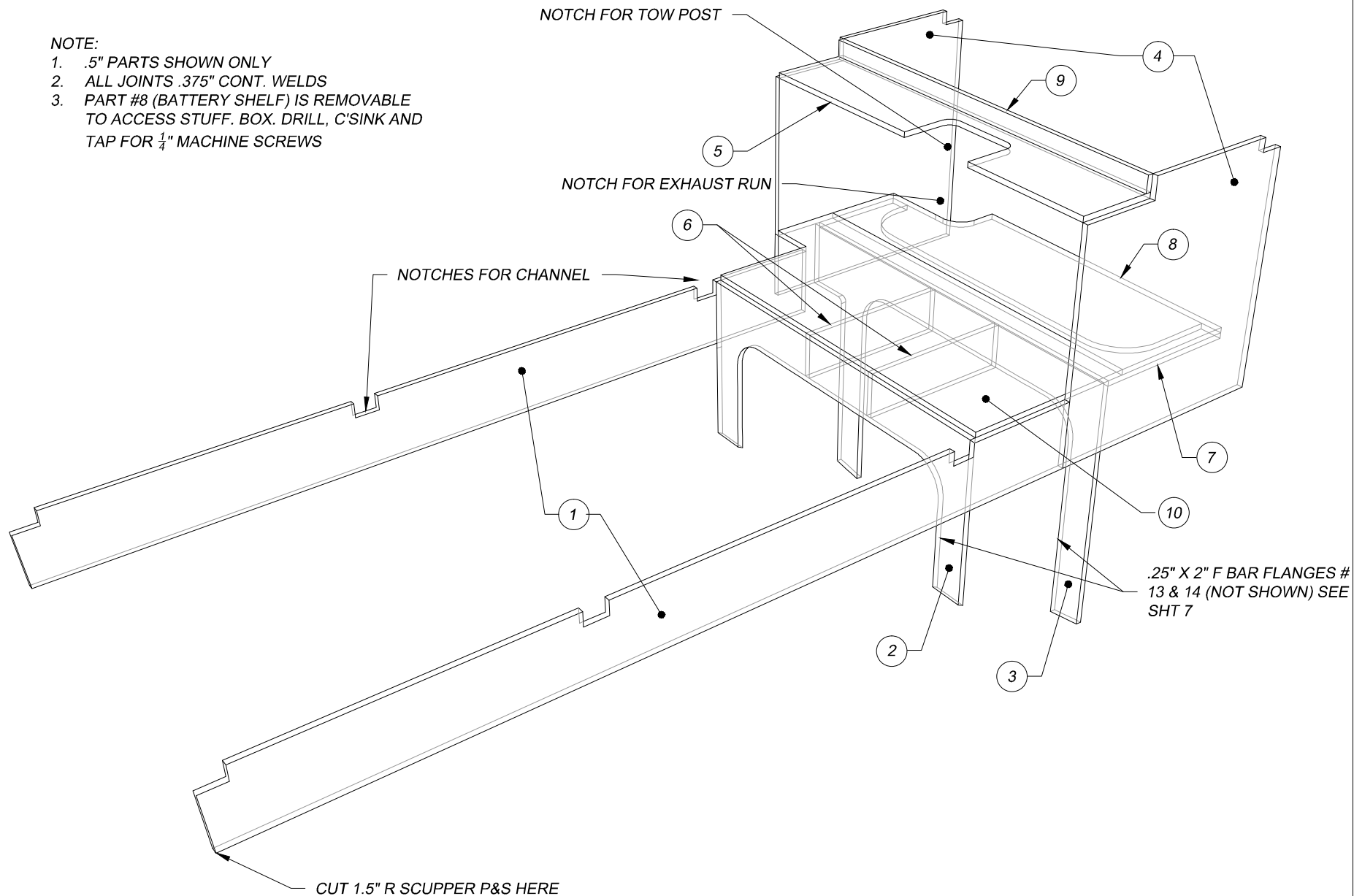

PROJECT: <b>FV INDIANA SEINE SKIFF</b>		TITLE: <b>TOW POST ASSEMBLY PERSP. (.5" PLATE ONLY)</b>	
<b>COASTWISE MARINE DESIGN INC.</b> COASTWISEMARINEDESIGN@GMAIL.COM 360-301-6400		<b>NORTHWINDS WELDING INC.</b> peter@northwindswelding.com 360-379-0487	
DATE:	APRIL 20, 2014	DESIGNED BY:	ANTONIO SALGUERO
SCALE:	NTS	SHEET:	3 OF 21

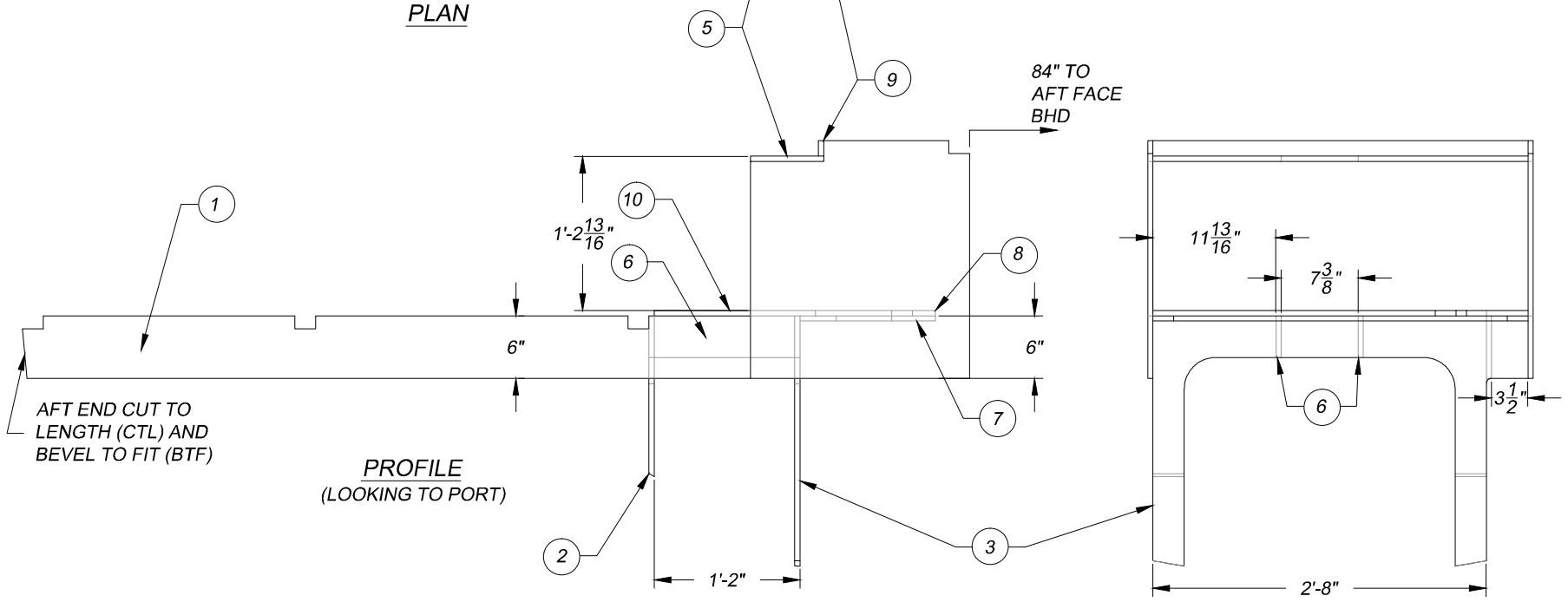
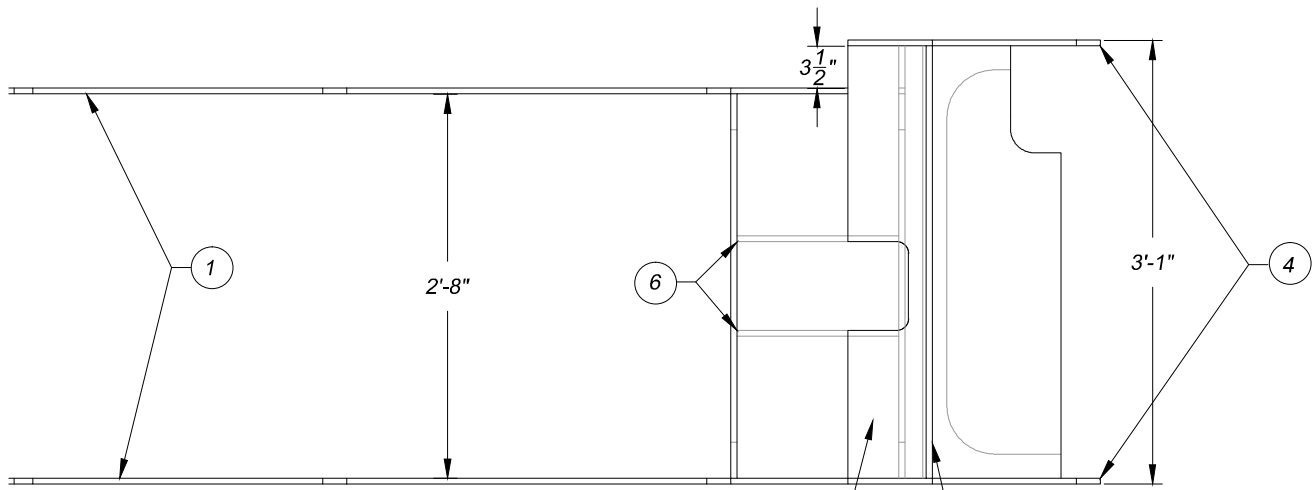

PROJECT: FV INDIANA SEINE SKIFF		TITLE: TOW POST ASSEMBLY 3 VIEW (.5" PLATE ONLY)	
<b>COASTWISE MARINE DESIGN INC.</b> COASTWISEMARINEDESIGN@GMAIL.COM 360-301-6400	<b>NORTHWINDS WELDING INC.</b> peter@northwindswelding.com 360-379-0487	DATE: APRIL 20, 2014	DESIGNED BY: ANTONIO SALGUERO
		SCALE: 1" = 1'	SHEET: 4 OF 21

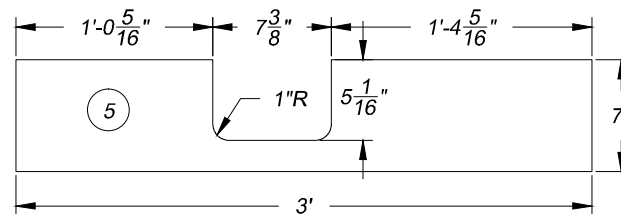
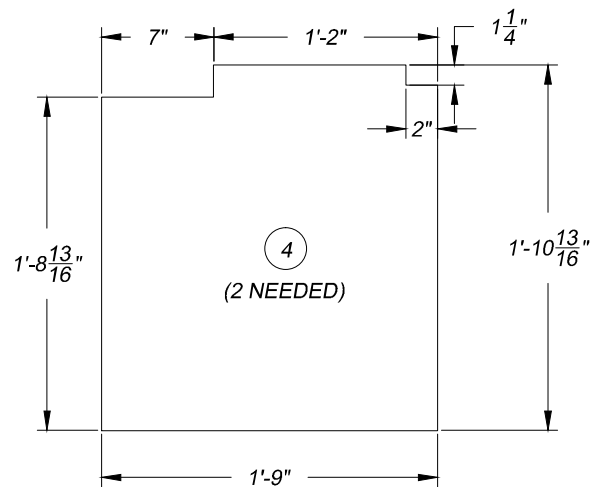
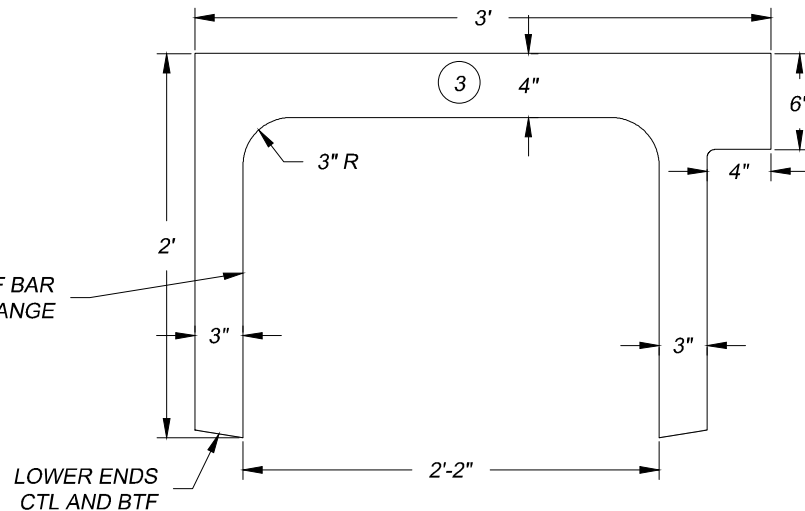
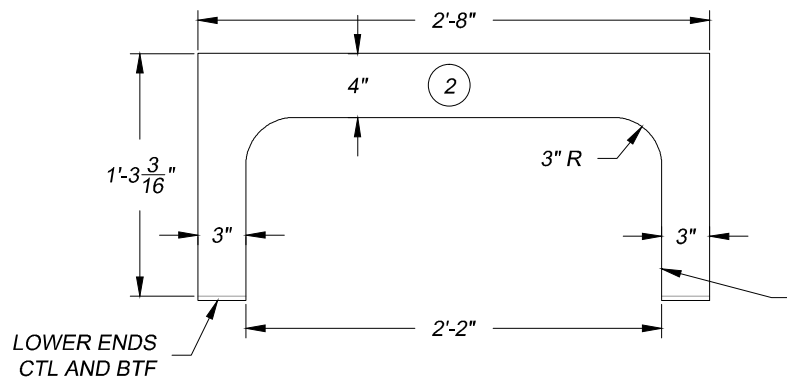
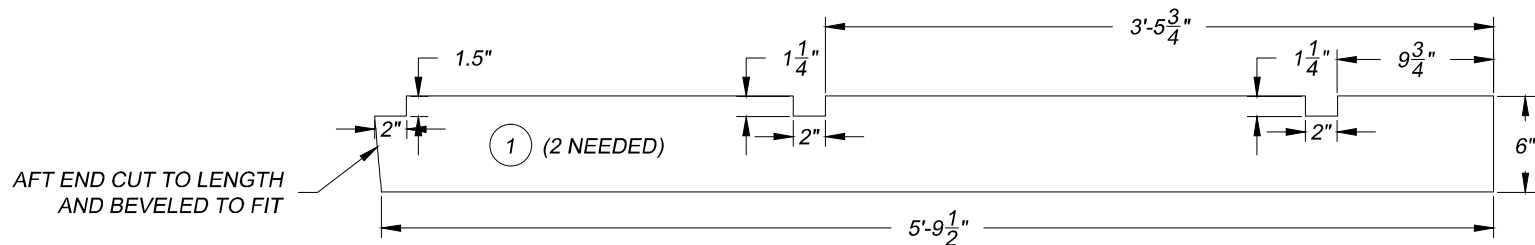

PROJECT: FV INDIANA SEINE SKIFF

TITLE: LOFTING FOR TOW POST ASSEMBLY PARTS (.5" PLATE ONLY)

**COASTWISE MARINE DESIGN INC.**  
COASTWISEMARINEDESIGN@GMAIL.COM  
360-301-6400

**NORTHWINDS WELDING INC.**  
peter@northwindswelding.com  
360-379-0487

DATE: APRIL 20, 2014

DESIGNED BY: ANTONIO SALGUERO

SCALE: 1" = 1'

SHEET: 5 OF 21

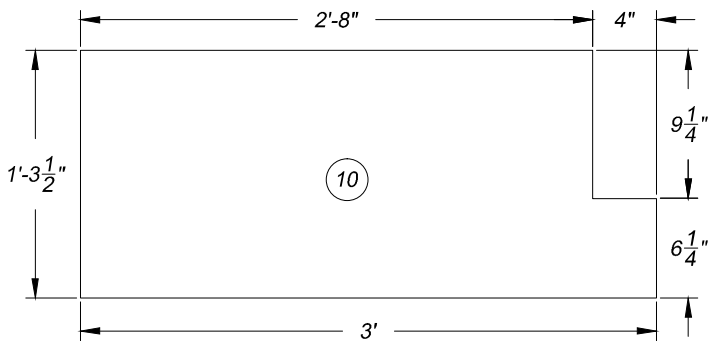
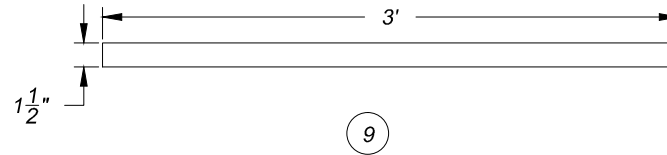
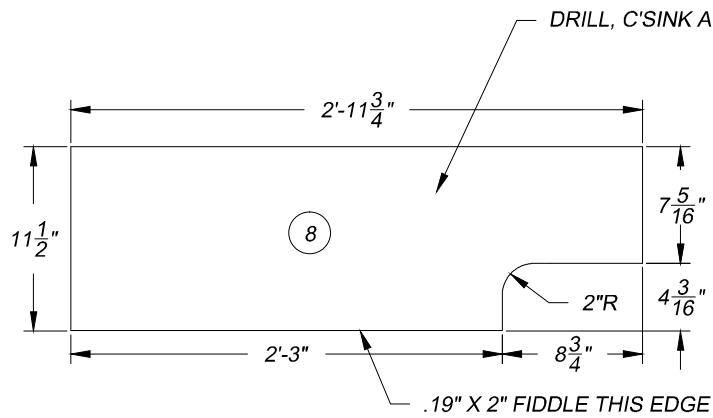
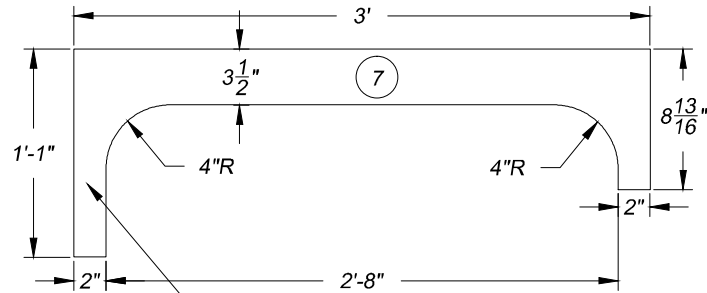
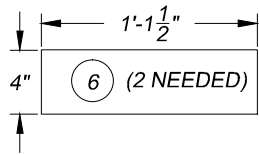

DRILL, C'SINK AND TAP FOR 1/4" FHMS

.19" X 2" FIDDLE THIS EDGE

PROJECT: FV INDIANA SEINE SKIFF

TITLE: LOFTING FOR TOW POST ASSEMBLY PARTS (.5" PLATE ONLY)

**COASTWISE MARINE DESIGN INC.**  
 COASTWISEMARINEDESIGN@GMAIL.COM  
 360-301-6400

**NORTHWINDS WELDING INC.**  
 peter@northwindswelding.com  
 360-379-0487

DATE: APRIL 20, 2014

DESIGNED BY: ANTONIO SALGUERO

SCALE: 1" = 1'

SHEET: 6 OF 21

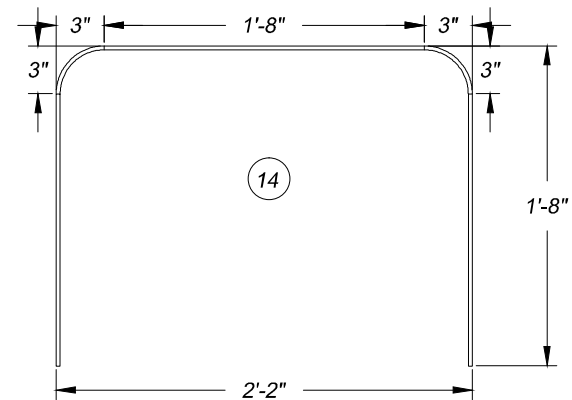
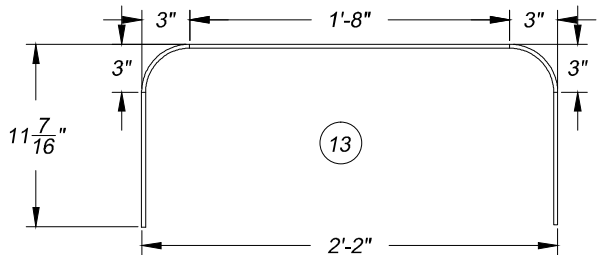
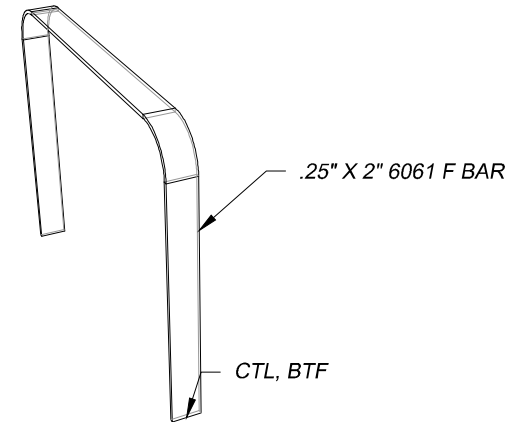
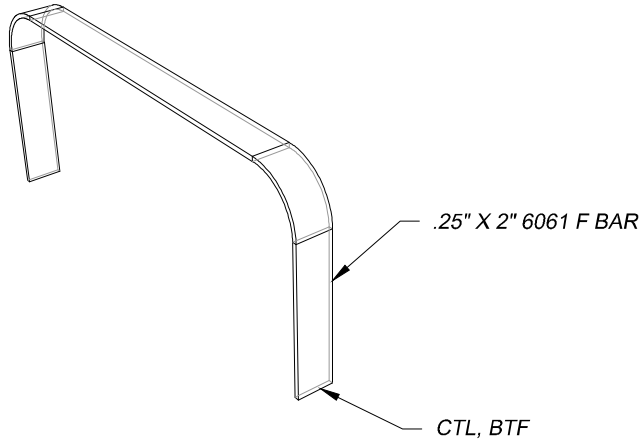
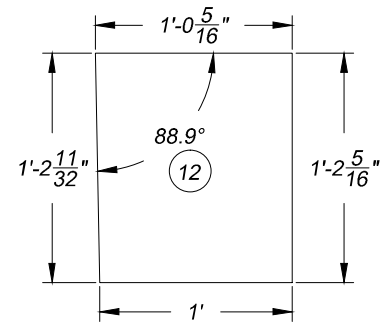
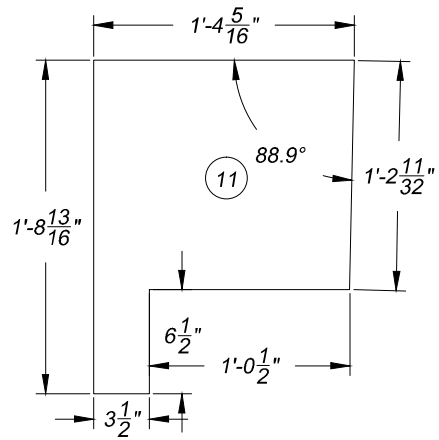

PROJECT: FV INDIANA SEINE SKIFF

TITLE: LOFTING FOR TOW POST ASSEMBLY PARTS (.25" PLATE ONLY)

**COASTWISE MARINE DESIGN INC.**  
 COASTWISEMARINEDESIGN@GMAIL.COM  
 360-301-6400

**NORTHWINDS WELDING INC.**  
 peter@northwindswelding.com  
 360-379-0487

DATE: APRIL 20, 2014

DESIGNED BY: ANTONIO SALGUERO

SCALE: 1" = 1'

SHEET: 7 OF 21

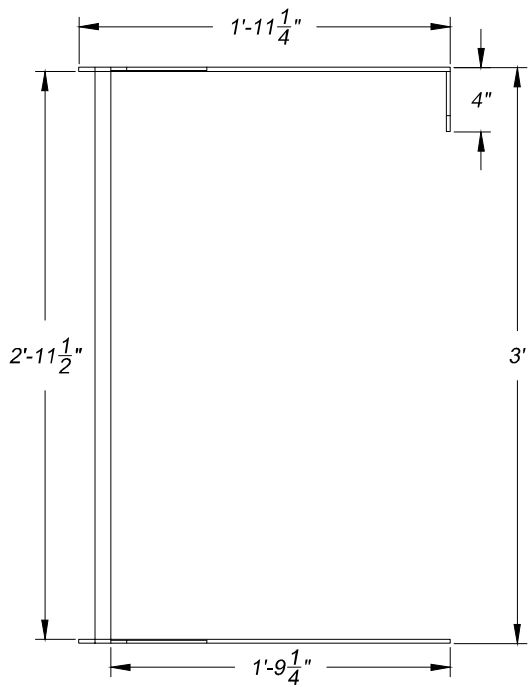

PLAN

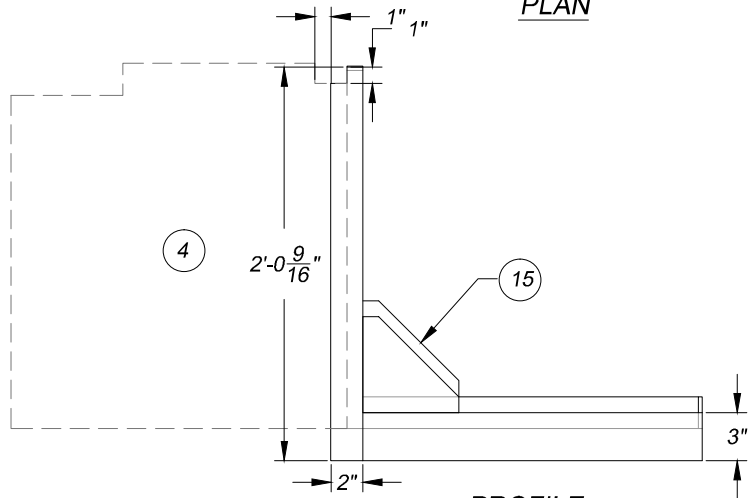
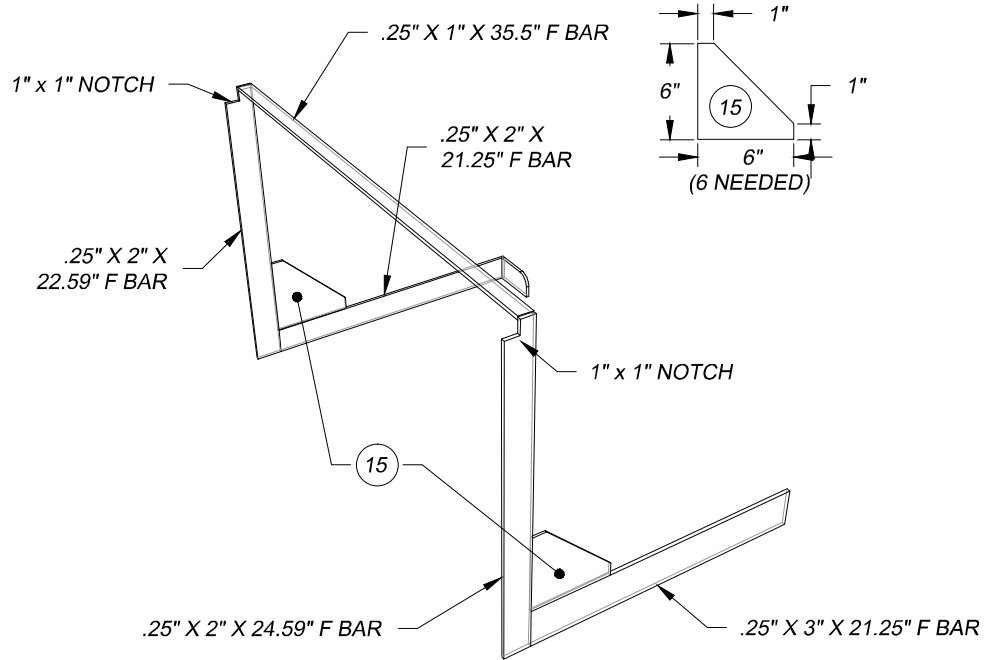

PROFILE  
(LOOKING TO PORT)

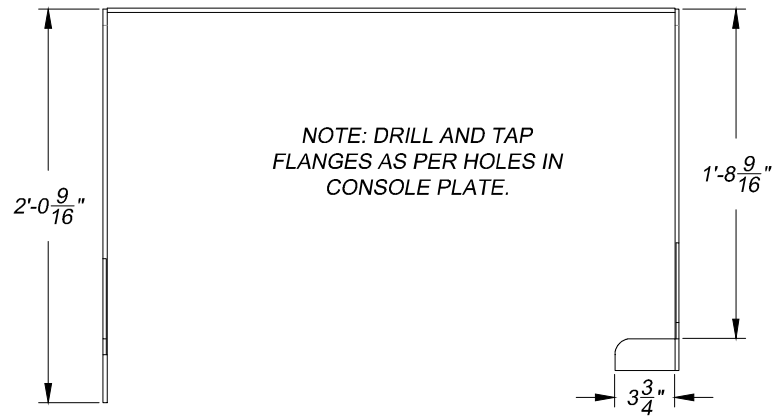

ELEVATION  
(LOOKING AFT)

PROJECT: FV INDIANA SEINE SKIFF

TITLE: FLANGE ASSEMBLY FOR CONSOLE (.25" PLATE)

**COASTWISE MARINE DESIGN INC.**  
COASTWISEMARINEDESIGN@GMAIL.COM  
360-301-6400

**NORTHWINDS WELDING INC.**  
peter@northwindswelding.com  
360-379-0487

DATE: APRIL 20, 2014

DESIGNED BY: ANTONIO SALGUERO

SCALE: 1" = 1'

SHEET: 8 OF 21



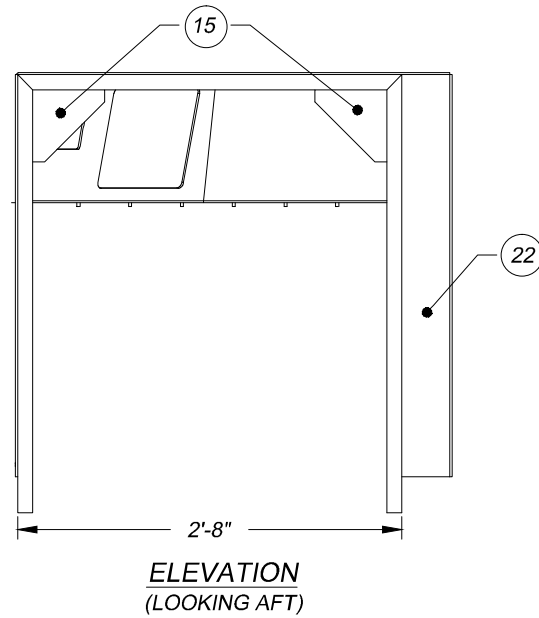
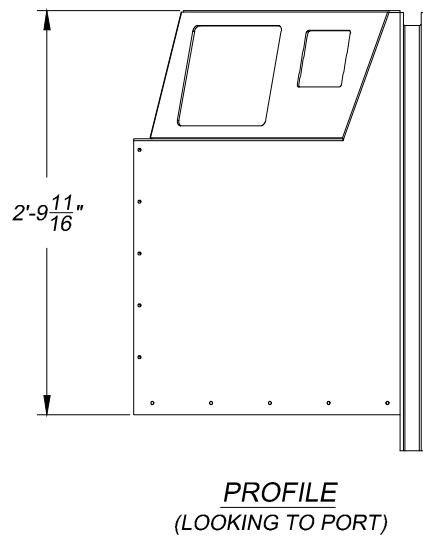
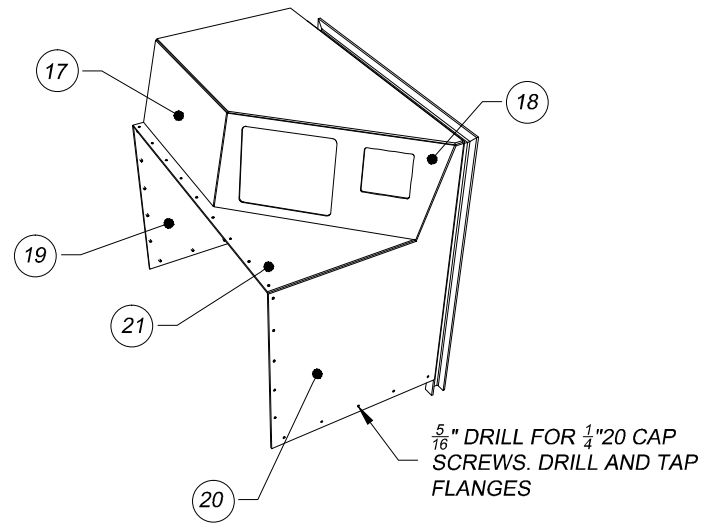
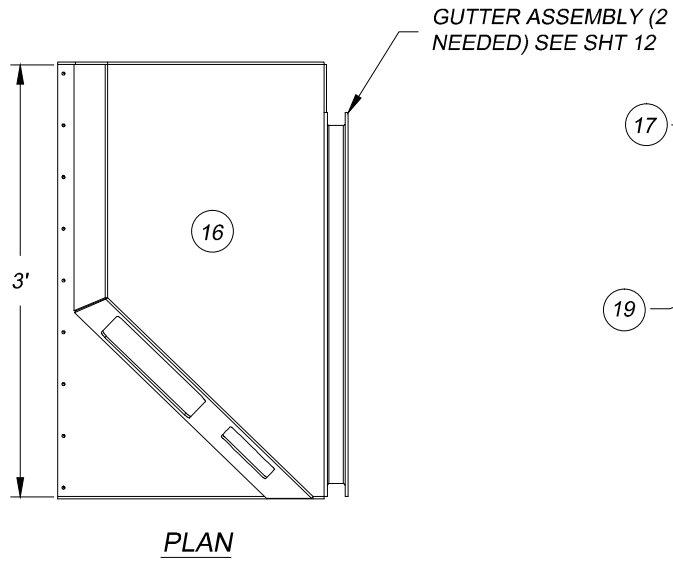

PROJECT: <b>FV INDIANA SEINE SKIFF</b>		TITLE: <b>CONSOLE ASSEMBLY (.19" PLATE)</b>	
<b>COASTWISE MARINE DESIGN INC.</b> COASTWISEMARINEDESIGN@GMAIL.COM 360-301-6400		<b>NORTHWINDS WELDING INC.</b> peter@northwindswelding.com 360-379-0487	
DATE: <b>APRIL 20, 2014</b>		DESIGNED BY: <b>ANTONIO SALGUERO</b>	
SCALE: <b>3/4" = 1'</b>		SHEET: <b>9 OF 21</b>	

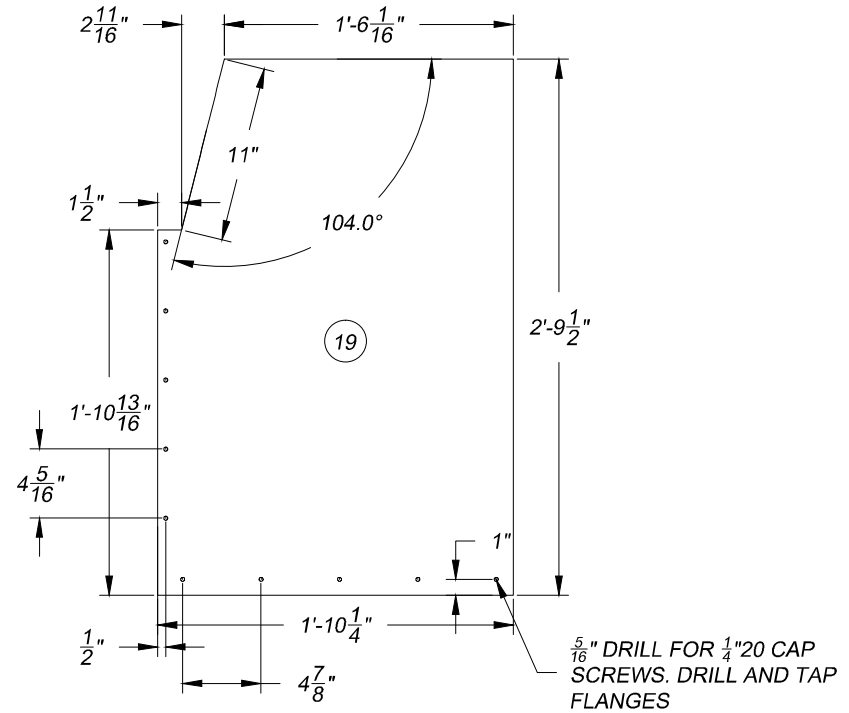
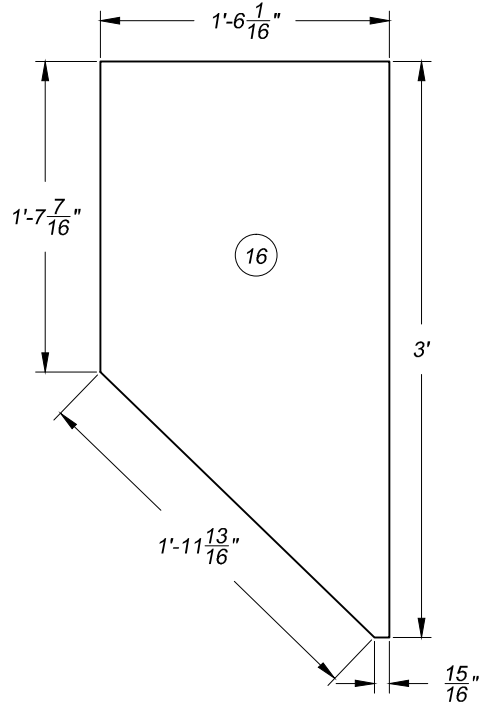
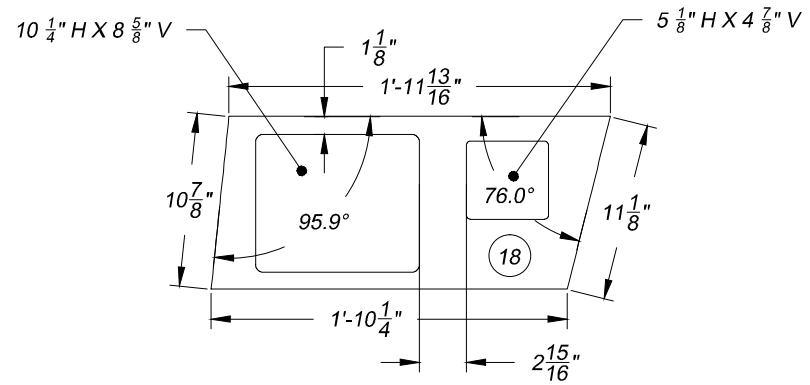
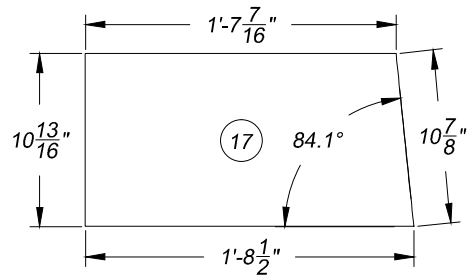

PROJECT: FV INDIANA SEINE SKIFF

TITLE: LOFTING FOR CONSOLE PARTS (.19" PLATE)

**COASTWISE MARINE DESIGN INC.**  
COASTWISEMARINEDESIGN@GMAIL.COM  
360-301-6400

**NORTHWINDS WELDING INC.**  
peter@northwindswelding.com  
360-379-0487

DATE: APRIL 20, 2014

DESIGNED BY: ANTONIO SALGUERO

SCALE: 1" = 1'

SHEET: 10 OF 21

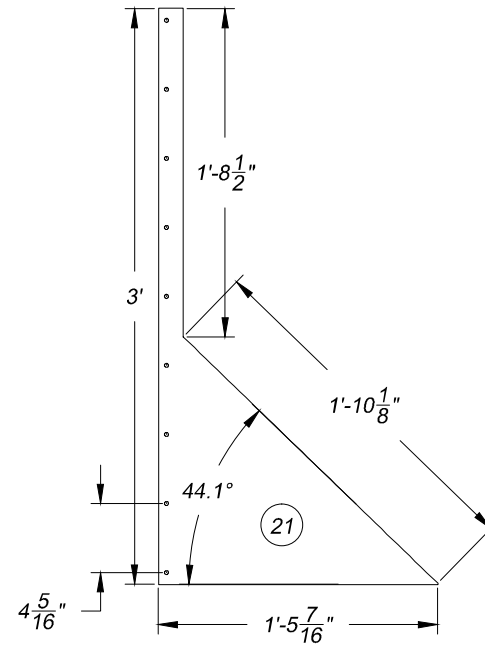
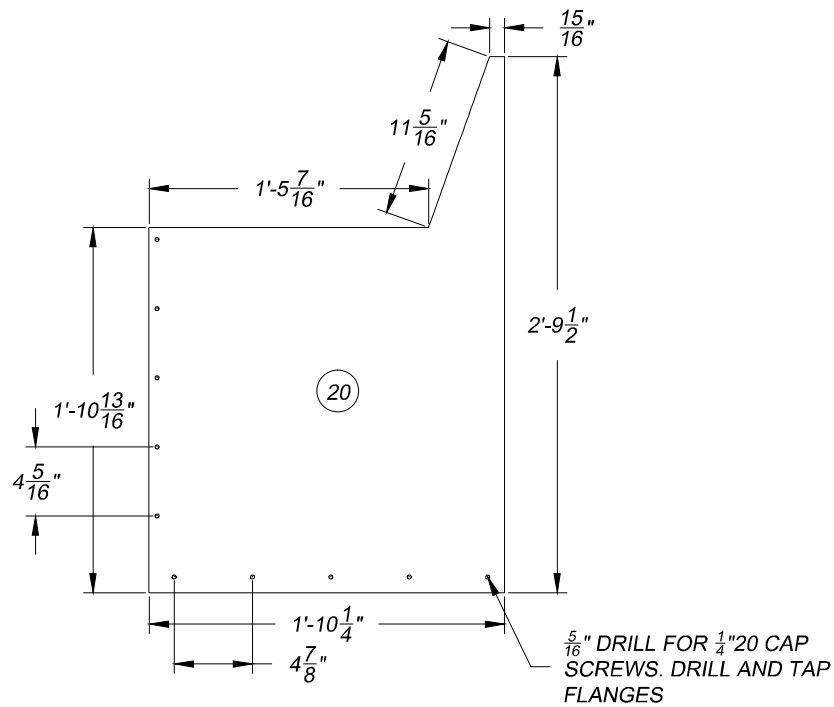
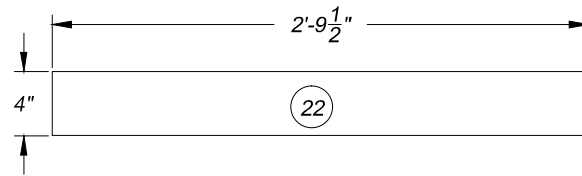

PROJECT: FV INDIANA SEINE SKIFF

TITLE: LOFTING FOR CONSOLE PARTS (.19" PLATE)

**COASTWISE MARINE DESIGN INC.**  
 COASTWISEMARINEDESIGN@GMAIL.COM  
 360-301-6400

**NORTHWINDS WELDING INC.**  
 peter@northwindswelding.com  
 360-379-0487

DATE: APRIL 20, 2014

DESIGNED BY: ANTONIO SALGUERO

SCALE: 1" = 1'

SHEET: 11 OF 21

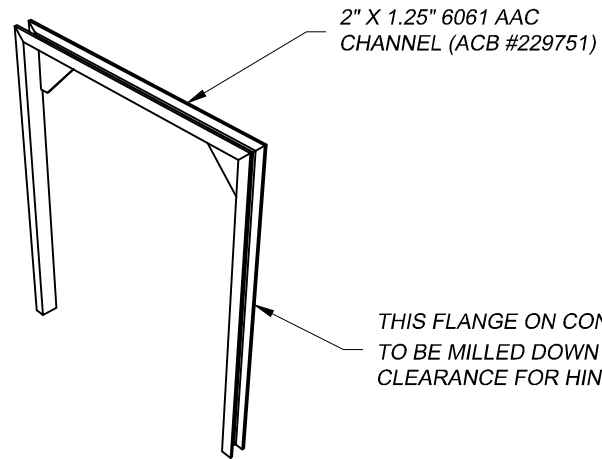

THIS FLANGE ON CONSOLE GUTTER MAY NEED TO BE MILLED DOWN  $\frac{1}{16}$ " TO PROVIDE CLEARANCE FOR HINGING HATCH

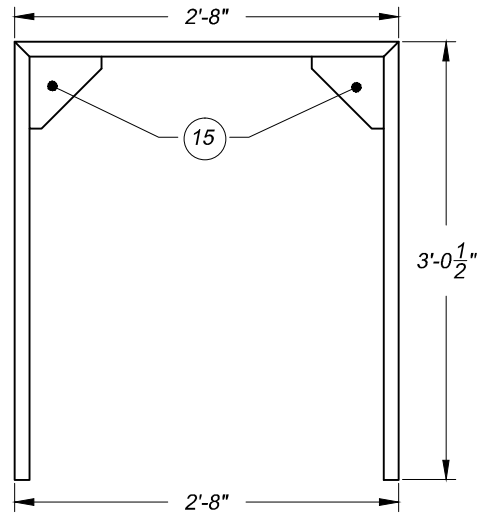

PROJECT: **FV INDIANA SEINE SKIFF**

TITLE: **GUTTER ASSEMBLY (2 NEEDED)**

**COASTWISE MARINE DESIGN INC.**  
 COASTWISEMARINEDESIGN@GMAIL.COM  
 360-301-6400

**NORTHWINDS WELDING INC.**  
 peter@northwindswelding.com  
 360-379-0487

DATE: **APRIL 20, 2014**

DESIGNED BY: **ANTONIO SALGUERO**

SCALE:  **$\frac{3}{4}$ " = 1'**

SHEET: **12 OF 21**

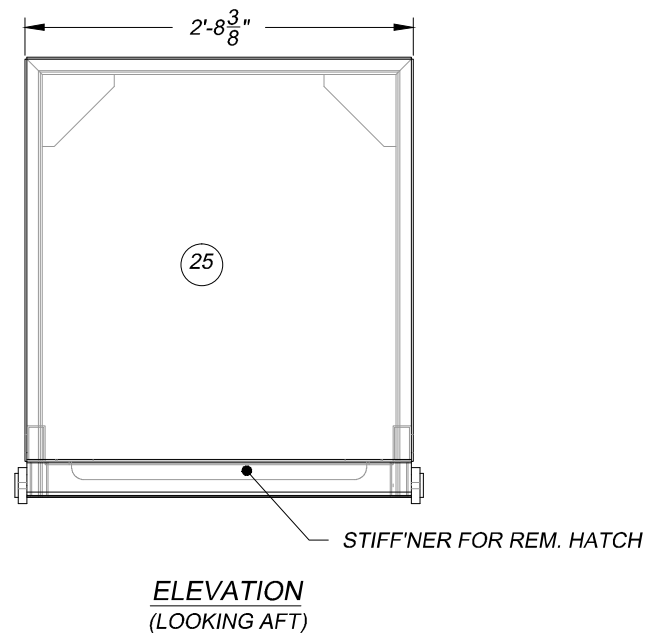
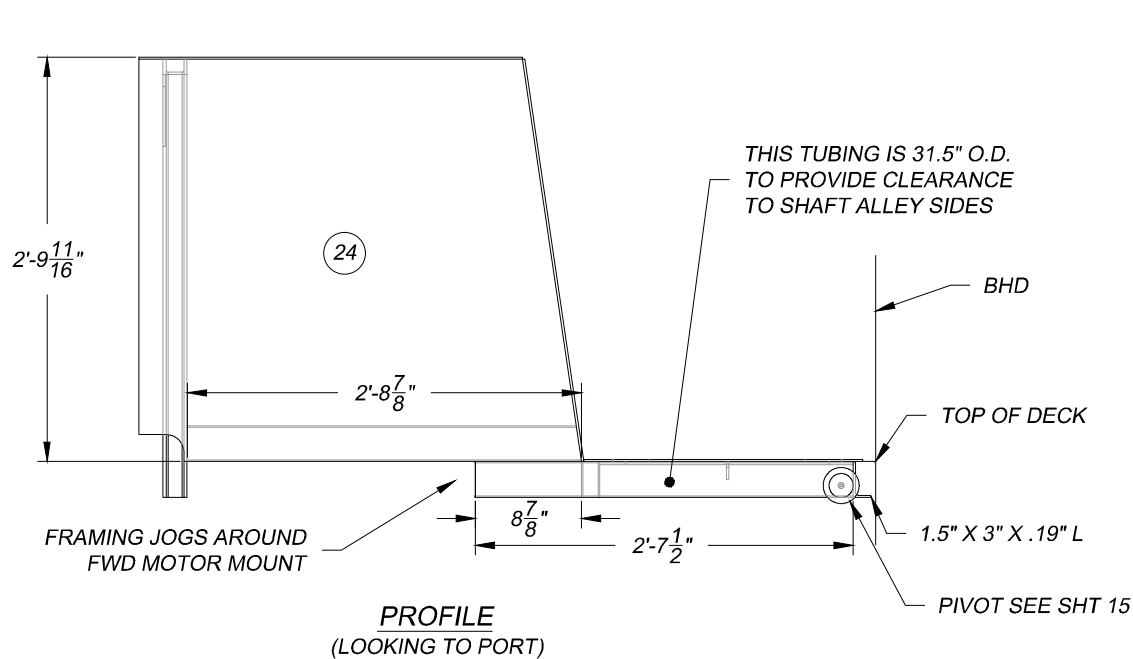
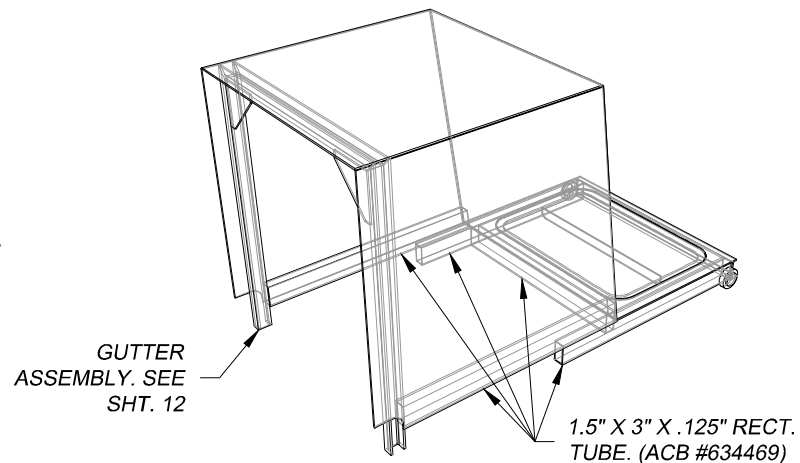
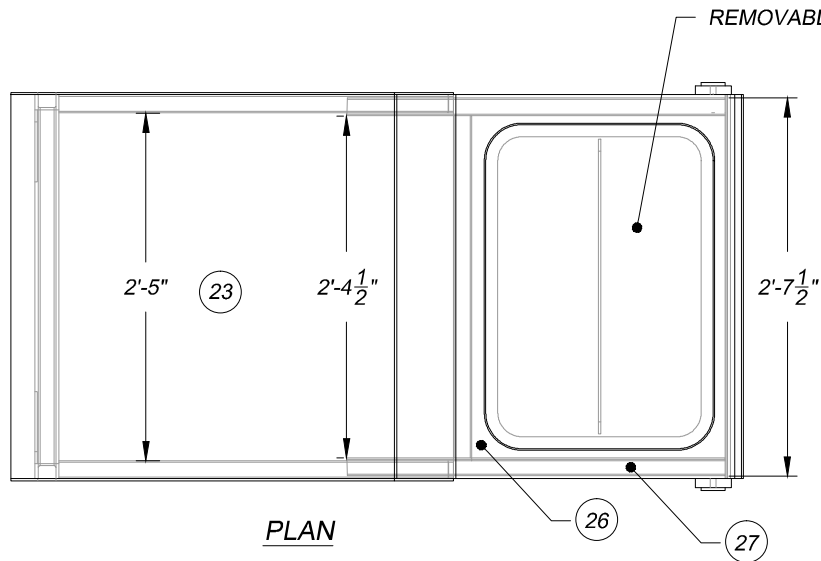

PROJECT: **FV INDIANA SEINE SKIFF**

TITLE: **HINGING ENGINE HATCH ASSEMBLY**

**COASTWISE MARINE DESIGN INC.**  
COASTWISEMARINEDESIGN@GMAIL.COM  
360-301-6400

**NORTHWINDS WELDING INC.**  
peter@northwindswelding.com  
360-379-0487

DATE: **APRIL 20, 2014**

DESIGNED BY: **ANTONIO SALGUERO**

SCALE: **3/4" = 1'**

SHEET: **13 OF 21**

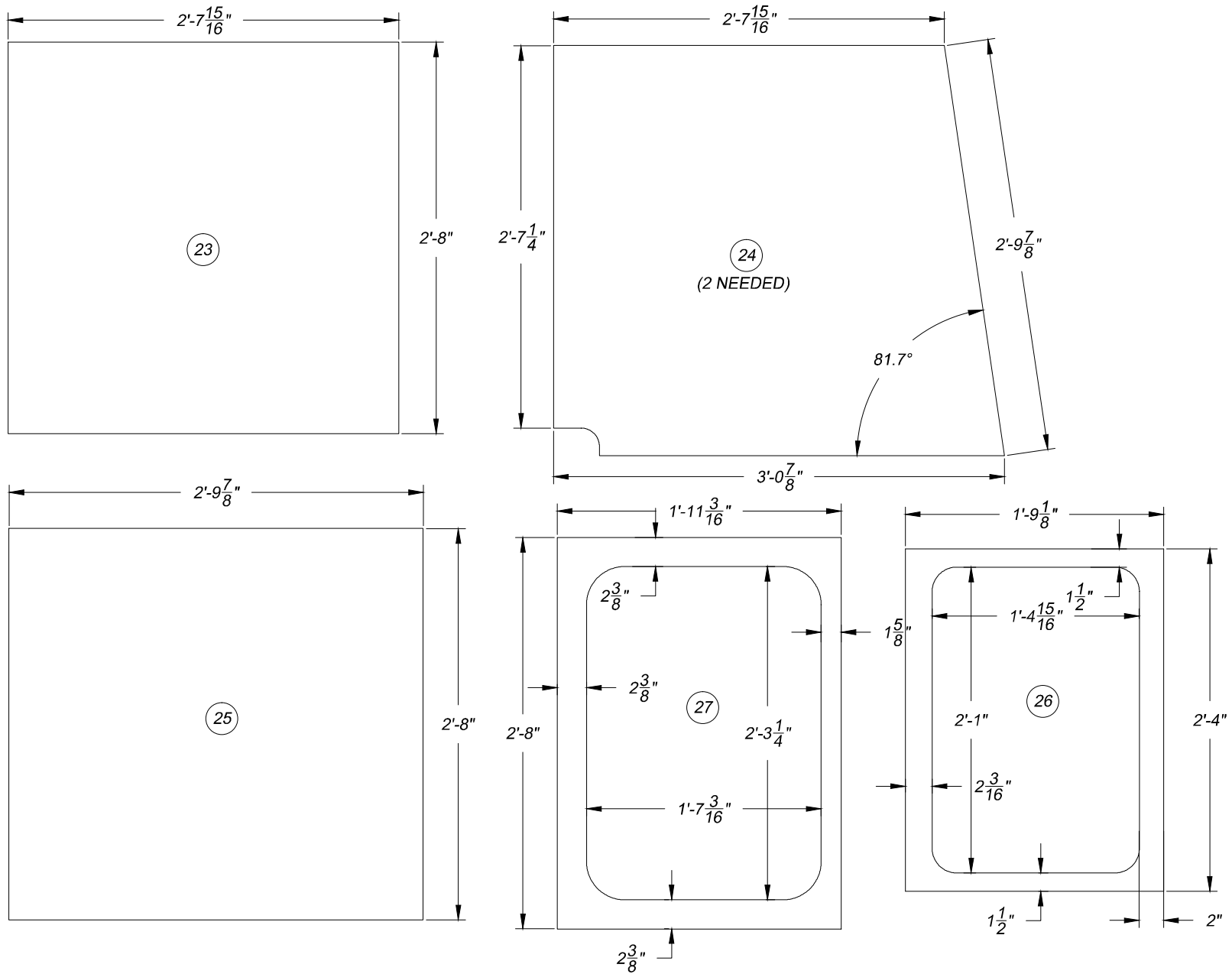

PROJECT: FV INDIANA SEINE SKIFF

TITLE: LOFTING FOR HINGING ENGINE HATCH PARTS (.19" PLATE)

**COASTWISE MARINE DESIGN INC.**  
 COASTWISEMARINEDESIGN@GMAIL.COM  
 360-301-6400

**NORTHWINDS WELDING INC.**  
 peter@northwindswelding.com  
 360-379-0487

DATE: APRIL 20, 2014

DESIGNED BY: ANTONIO SALGUERO

SCALE: 1" = 1'

SHEET: 14 OF 21

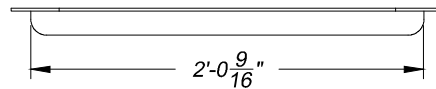
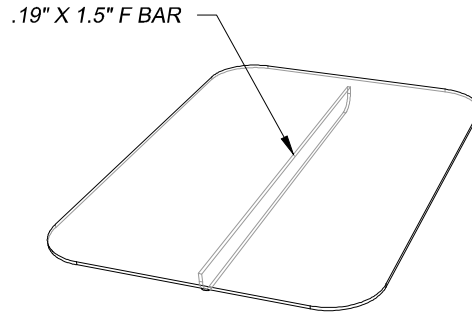
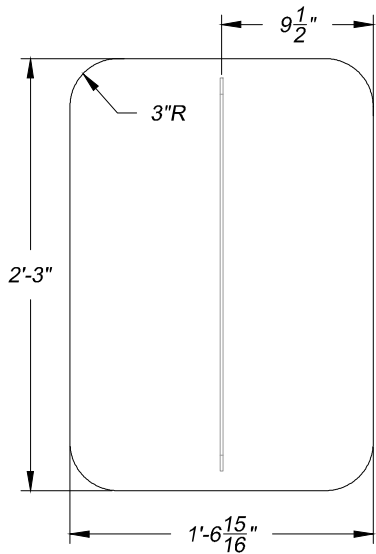

REMOVABLE HATCH

SCALE: 1" = 1'

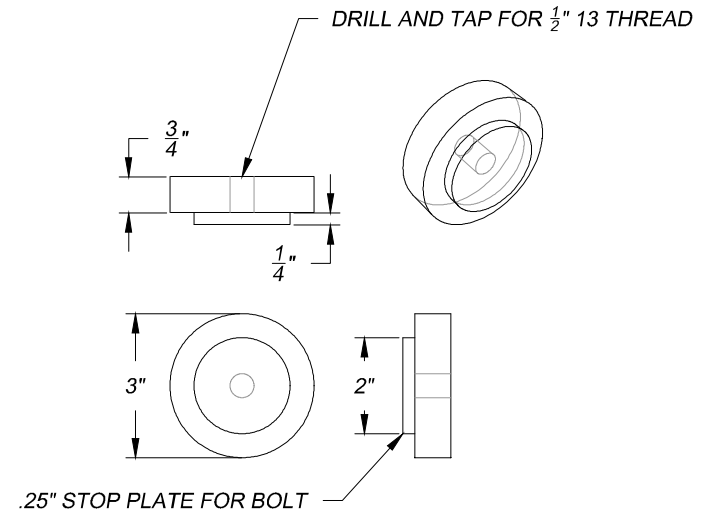

PIVOT: .75\"/>

SCALE: 3" = 1'

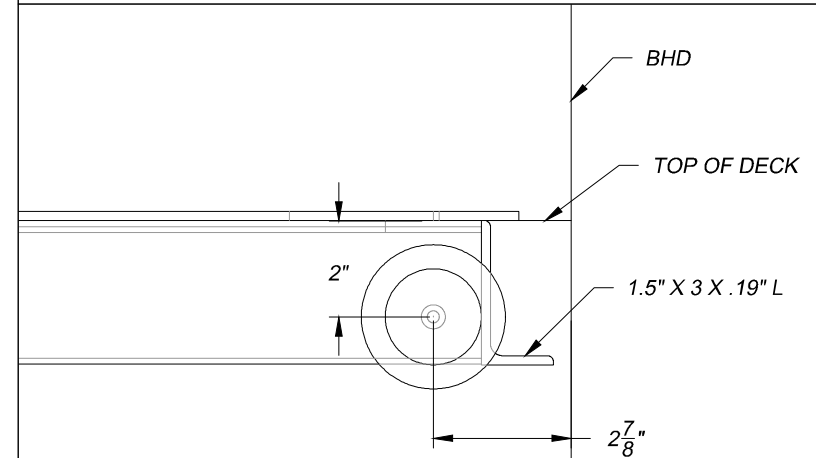

NOTE:  
 LOCATE PIVOT AS SHOWN. USE 3" HOLE SAW TO CUT HOLE FOR PIVOT.  
 USE TEMP. 1/2" ALL THREAD ACROSS BOTH PIVOTS TO HOLD IN ALIGNMENT WHILE WELDING. REMOVE AFTER.

SCALE: 3" = 1'

PROJECT: **FV INDIANA SEINE SKIFF**

TITLE: **HINGING ENGINE HATCH PARTS**

**COASTWISE MARINE DESIGN INC.**  
 COASTWISEMARINEDESIGN@GMAIL.COM  
 360-301-6400

**NORTHWINDS WELDING INC.**  
 peter@northwindswelding.com  
 360-379-0487

DATE: **APRIL 20, 2014**

DESIGNED BY: **ANTONIO SALGUERO**

SCALE: **AS NOTED**

SHEET: **15 OF 21**

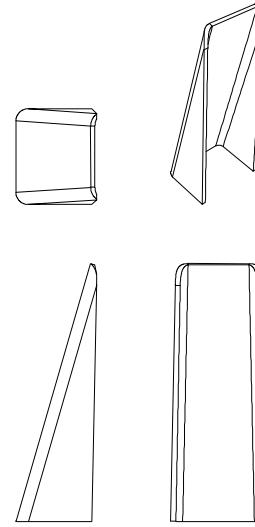
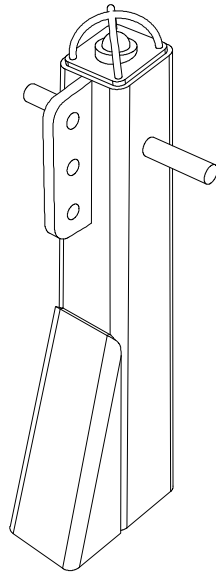
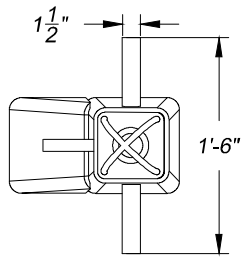

BRACE: .375" PLATE

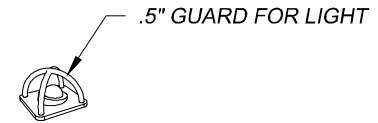
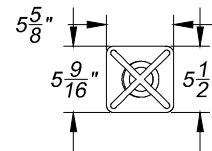
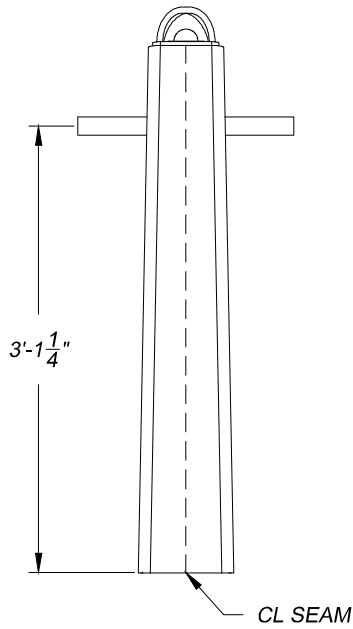
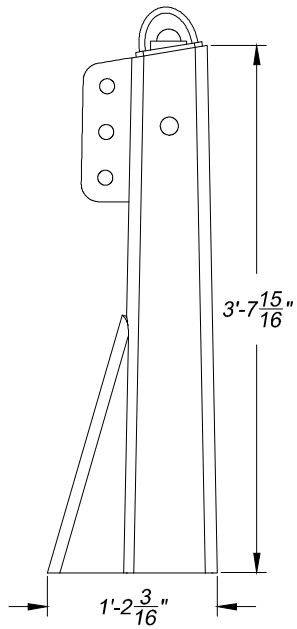

CAP PLATE: .375" PLATE

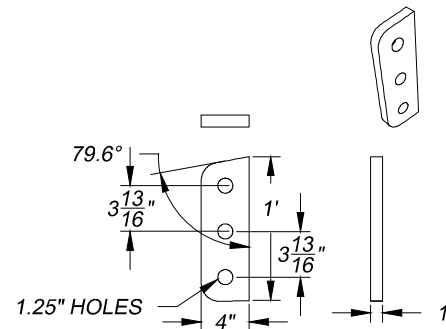

TOWING LUG: 1" PLATE

PROJECT: **FV INDIANA SEINE SKIFF**

TITLE: **TOWPOST (.5" PLATE)**

**COASTWISE MARINE DESIGN INC.**  
COASTWISEMARINEDESIGN@GMAIL.COM  
360-301-6400

**NORTHWINDS WELDING INC.**  
peter@northwindswelding.com  
360-379-0487

DATE: **APRIL 20, 2014**

DESIGNED BY: **ANTONIO SALGUERO**

SCALE: **3/4" = 1'**

SHEET: **16 OF 21**



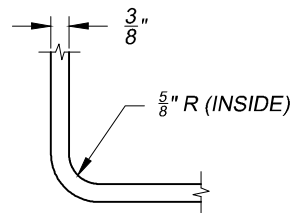
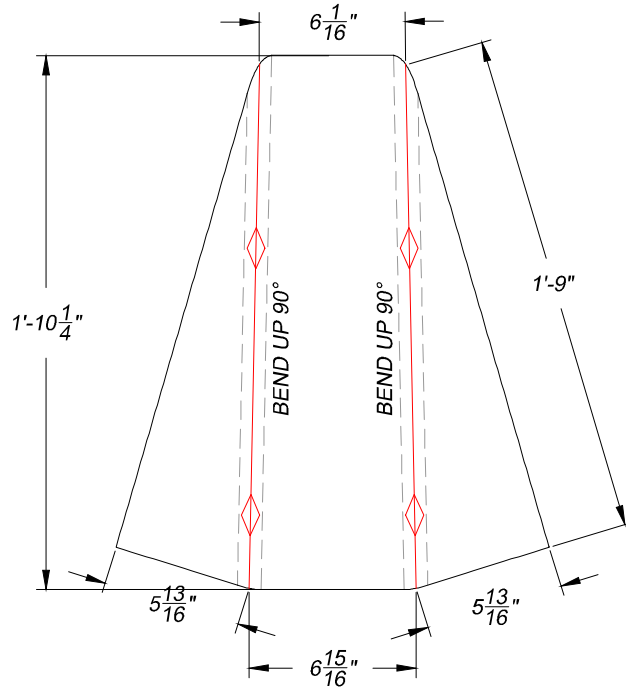

TYPICAL BRAKE RADIUS FOR TOWPOST  
SCALE: 3" = 1'

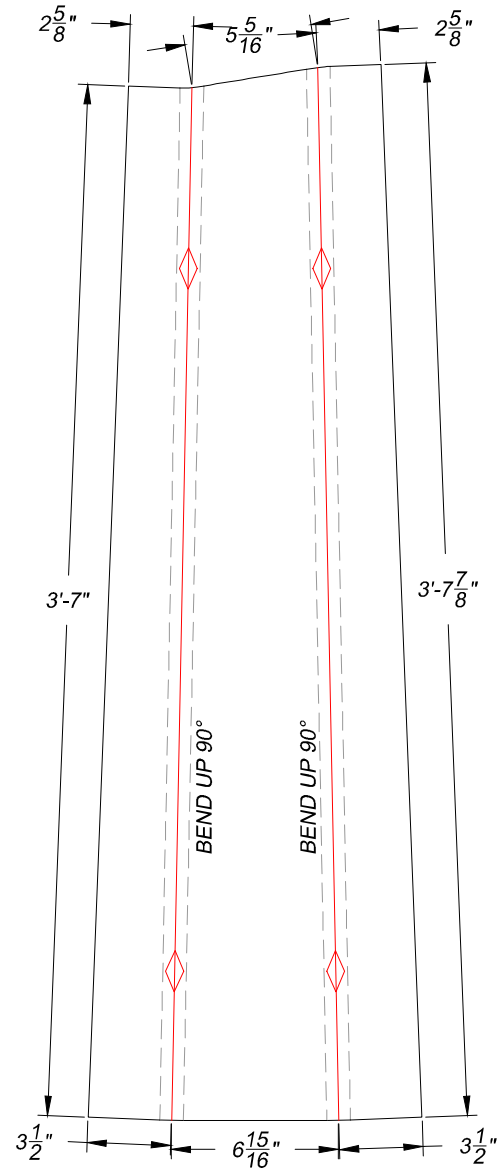

2 NEEDED MIRRORED

PROJECT: FV INDIANA SEINE SKIFF

TITLE: LOFTING FOR TOWPOST (.5" PLATE)

COASTWISE MARINE DESIGN INC.  
COASTWISEMARINEDESIGN@GMAIL.COM  
360-301-6400

NORTHWINDS WELDING INC.  
peter@northwindswelding.com  
360-379-0487

DATE: APRIL 20, 2014

DESIGNED BY: ANTONIO SALGUERO

SCALE: 1 1/2" = 1'

SHEET: 17 OF 21

**CAP PLATE:**  
.125" PLATE

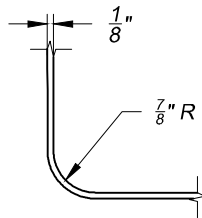
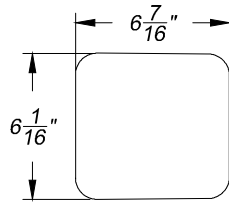

TYPICAL BRAKE RADIUS FOR COLUMN  
SCALE: 3" = 1'

2 NEEDED MIRRORED

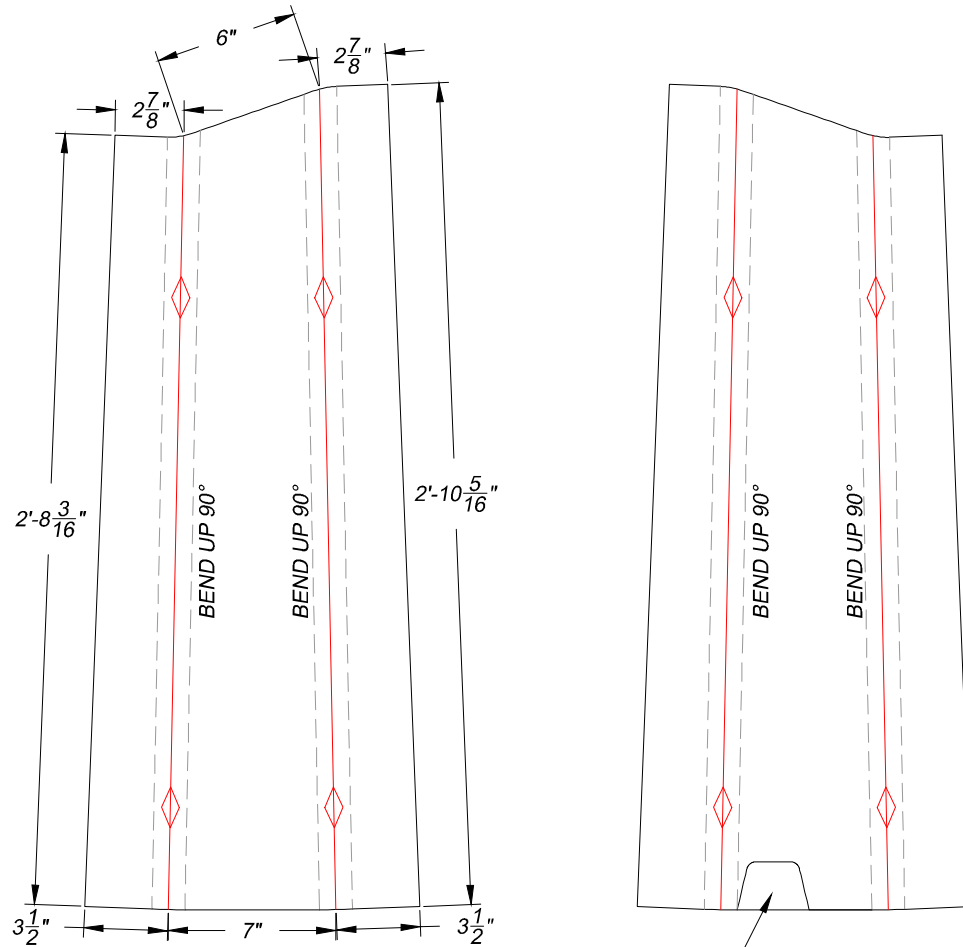

NOTCH FOR HULL STIFF CHASEWAY  
FOR STEERING HOSES. CHASEWAY  
EXTENDS ON DECK FROM COLUMN TO  
CONSOLE GUTTER

PROJECT: **FV INDIANA SEINE SKIFF**

TITLE: **LOFTING FOR STEERING COLUMN (.125" PLATE)**

**COASTWISE MARINE DESIGN INC.**  
COASTWISEMARINEDESIGN@GMAIL.COM  
360-301-6400

**NORTHWINDS WELDING INC.**  
peter@northwindswelding.com  
360-379-0487

DATE: **APRIL 20, 2014**

DESIGNED BY: **ANTONIO SALGUERO**

SCALE: **1 1/2" = 1'**

SHEET: **18 OF 21**

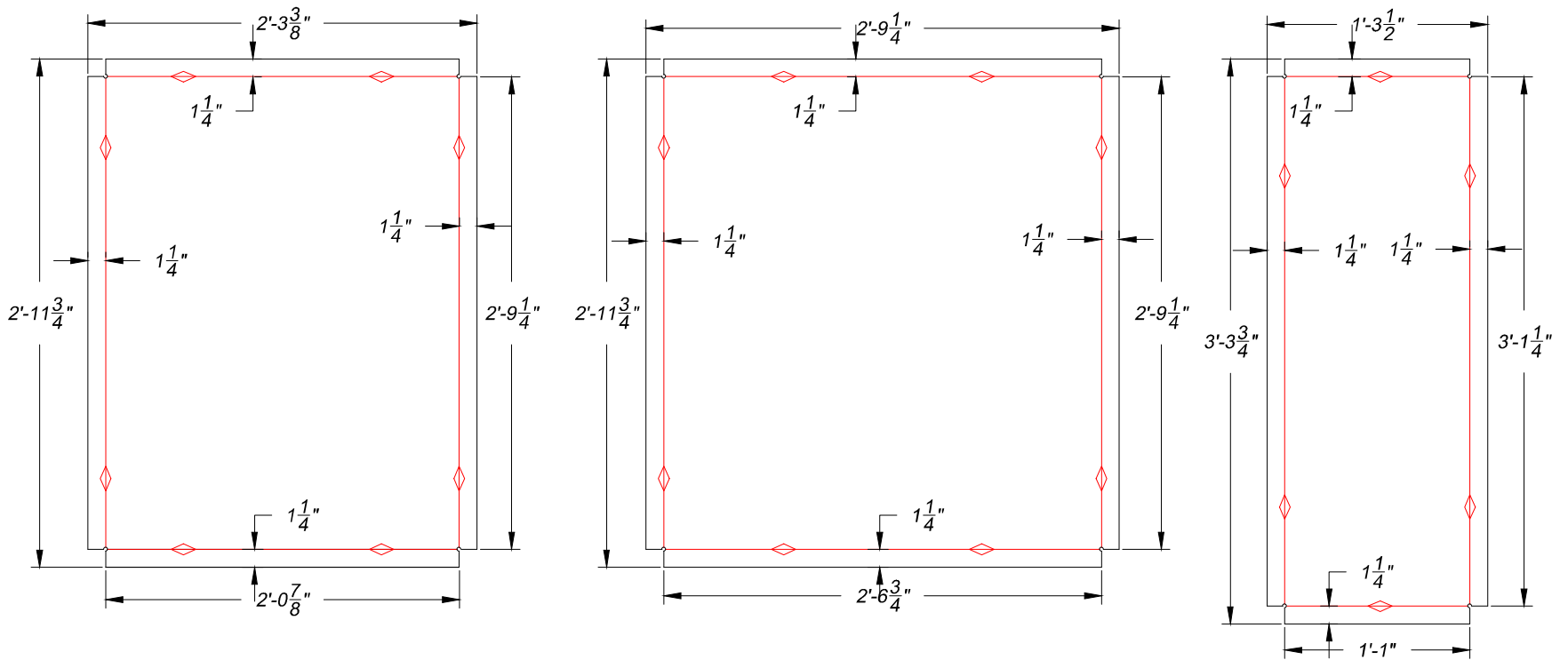

ALL BRAKES 90 DEGREES

PROJECT: **FV INDIANA SEINE SKIFF**

TITLE: **LOFTING FOR REMOVABLE HATCHES (.19" PLATE)**

**COASTWISE MARINE DESIGN INC.**  
 COASTWISEMARINEDESIGN@GMAIL.COM  
 360-301-6400

**NORTHWINDS WELDING INC.**  
 peter@northwindswelding.com  
 360-379-0487

DATE: **APRIL 20, 2014**

DESIGNED BY: **ANTONIO SALGUERO**

SCALE: **1" = 1'**

SHEET: **19 OF 21**

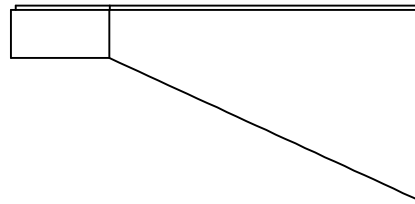
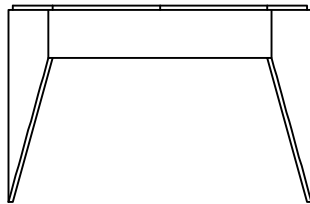
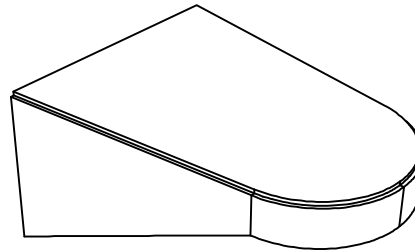
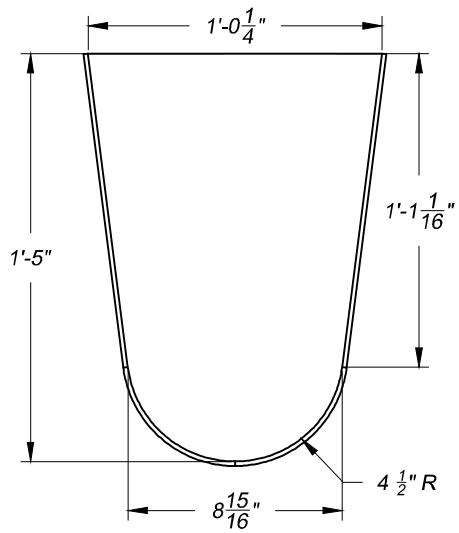

PROJECT: **FV INDIANA SEINE SKIFF**

TITLE: **HELM SEAT (.19" PLATE)**

**COASTWISE MARINE DESIGN INC.**  
 COASTWISEMARINEDESIGN@GMAIL.COM  
 360-301-6400

**NORTHWINDS WELDING INC.**  
 peter@northwindswelding.com  
 360-379-0487

DATE: **APRIL 20, 2014**

DESIGNED BY: **ANTONIO SALGUERO**

SCALE: **1" = 1'**

SHEET: **20 OF 21**

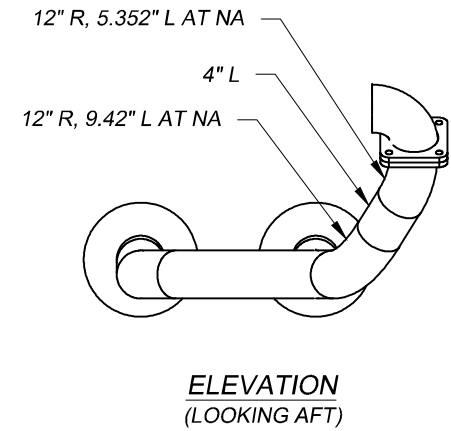
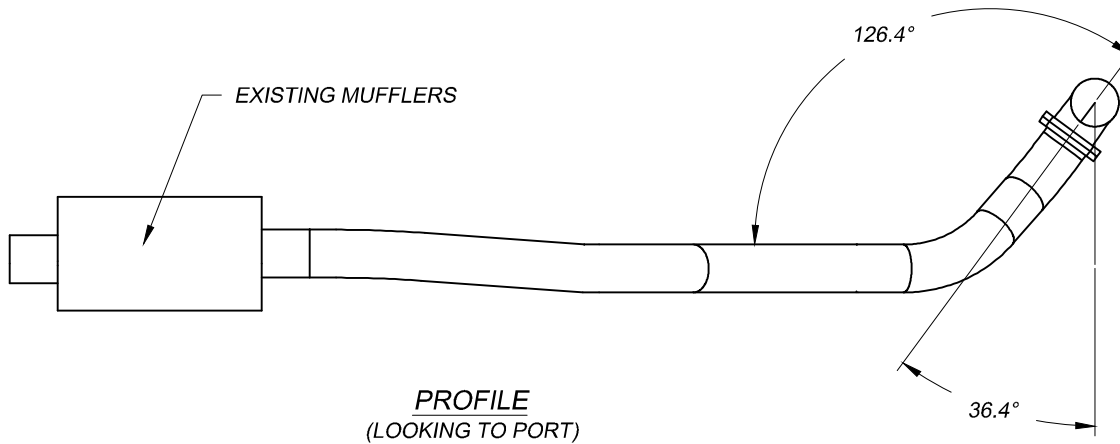
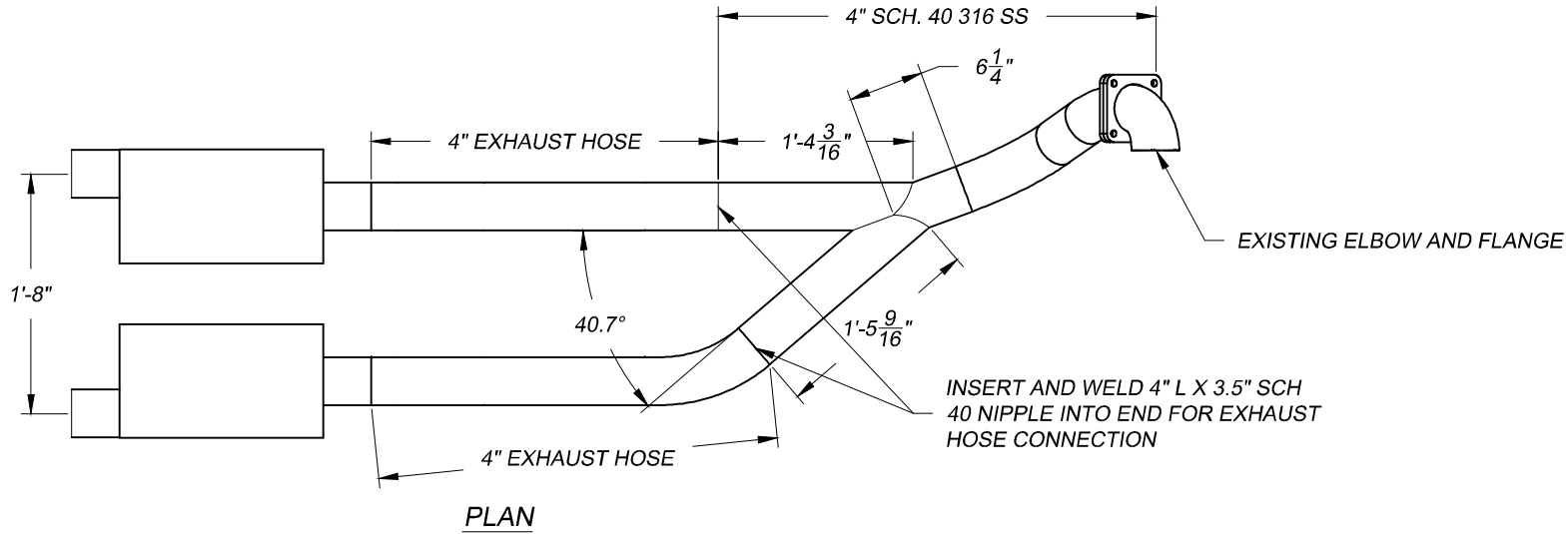

NA = NEUTRAL AXIS

PROJECT: **FV INDIANA SEINE SKIFF**

TITLE: **EXHAUST RUN**

**COASTWISE MARINE DESIGN INC.**  
COASTWISEMARINEDESIGN@GMAIL.COM  
360-301-6400

**NORTHWINDS WELDING INC.**  
peter@northwindswelding.com  
360-379-0487

DATE: **APRIL 20, 2014**

DESIGNED BY: **ANTONIO SALGUERO**

SCALE: **1" = 1'**

SHEET: **21 OF 21**